

Falcon Lifts

ISO 9001 : 2008 Certified



SAFETY | QUALITY | 100% CUSTOMIZATION

Our Vision

The rapid growth of the building industry and associated technologies demands parallel growth in the field of vertical transportation. Elevator industry needs qualified engineers in the field whose knowledge keeps pace with technological and scientific developments.

We know how important transport in a building. For us, the Customer and his demand is the center of our activity. That's why we build friendship with our customers.

Our team of experts would like to help you when the professional assistance is required. With the experience of past 14+ years (Otis, Schindler) we are here for you. We identify your requirement and provide opinion, advice, counsel and project for you. Our services under consulting includes, but not limited to, the followings.

New Installation :

Traffic Analysis : After fourteen plus years of experience, we can advise on how to specify the optimum elevators (speed, capacity, number of units, type of controller) based on actual standards and building requirements.

Planning : Building up a new facility is a difficult task. There are plenty of things to consider even for the basics. This is where the professional assistance can make things a lot easier for you. Traffic analysis, systems design, installation Documents, contract administration.

Maintenance :

Falcon Lifts currently provide maintenance service for elevators, manufactured and installed by us or by other lift companies.

Why Falcon Maintenance Service :

- Experienced Mechanical and Electrical Engineers who control and follow all callback data comes for technical department.
- Experienced and yearly trained and mobilized technicians and supervisors.
- Thousand spare parts are kept in warehouse.
- 24 hours service

Our Key-Point :

- **Engineers** - Estimate and Provide solutions for vertical transport in daily life
- **Designers** - Design according to requests, needs and standards.
- **Developers** - Follow technological developments, create new technologies.
- **Installers** - Have experienced and professional technicians for designed products.
- **Auditors** - Before public usage, all products are examined by our engineers.

We Are A Trustworthy Brand That Keeps People Moving :

For more than 14 plus year's of experience, Falcon Lifts and its engineers have been providing solutions with consulting, engineering, contracting and maintenance. We create value to your building by helping you move people around within comfort and safe.



Passenger Elevator: //



Compact in structure, attractive in design, with proven quality and short delivery time.

Passenger Elevator is the ideal solution for residential & commercial buildings with an outstanding price-performance ratio.

HIGHLIGHTS :

For Low-rise Buildings

Max. Speed : 1m/sec
Max. Load : Up to 680kg
Max. Travel : 24m
Max. Stops : 8 Stops

For mid & high-rise Buildings

Max. Speed : 1.75m/sec
Max. Load : Up to 2,000kg
Max. Travel : 75m
Max. Stops : 24 Stops

FALCON offers Passenger lifts for all types of low-mid-high rise buildings. Where passenger lifts are required, the buildings which house them are generally open environments, so it is important that the flow of people into, through, and out of them is efficiently controlled.

FALCON offers all types passenger lifts including manual doors, Automatic Power Doors, Capsule Elevators, etc, All the Elevators we supply, installation, testing & commissioning time we keeping in mind all the safety, speed and comfort provided.

Our passenger elevators are distributed in various series to fit the requirement of each and every type of building including affordable housing as well as premium housing.

Latest technology is used in the elevator for the machines, controllers, etc. so as to give reliability, superior comfort and better travel experience for the passengers.

There are two types of Passenger elevators

➤ **Automatic Elevators**

➤ **Manual Elevator**

Our highly qualified and experienced technical team will advise you on the best mobility solutions to meet your building and passenger requirements. They will support you throughout the entire process, from preliminary sketches to final delivery and commissioning.

Comfort. Enjoy a comfortable travel at a competitive price.

Technical Specifications

PASSENGER ELEVATOR - MANUAL DOOR

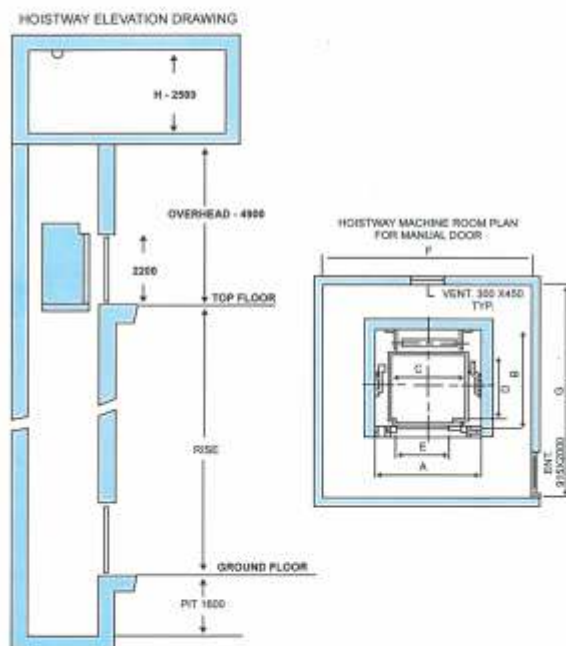

Hoist Way Machine Room Size Passenger Lift With Manually Operated Doors

LOAD		LIFT WELL		CAR INSIDE		ENTRANCE	MACHINE ROOM		
PERSON	WEIGHT	WIDTH	DEPTH	WIDTH	DEPTH		WIDTH	DEPTH	HEIGHT
IN KG.		A	B	C	D	E	F	G	H
4	272	1600	1250	1100	700	700	3000	3000	2500
5	340	1600	1300	1100	850	750	3000	3200	2500
6	408	1670	1370	1100	1000	750	3000	3500	2500
8	544	1800	1600	1300	1100	750	3200	3500	2500
10	680	1850	1800	1350	1300	1000	3500	4000	2500
13	884	2500	1600	2000	1100	1000	4000	4200	2500
16	1088	2500	1800	2000	1300	1000	4500	4800	2500
20	1360	2500	2050	2000	1550	1000	5000	5000	2500

PASSENGER ELEVATOR - AUTO DOOR

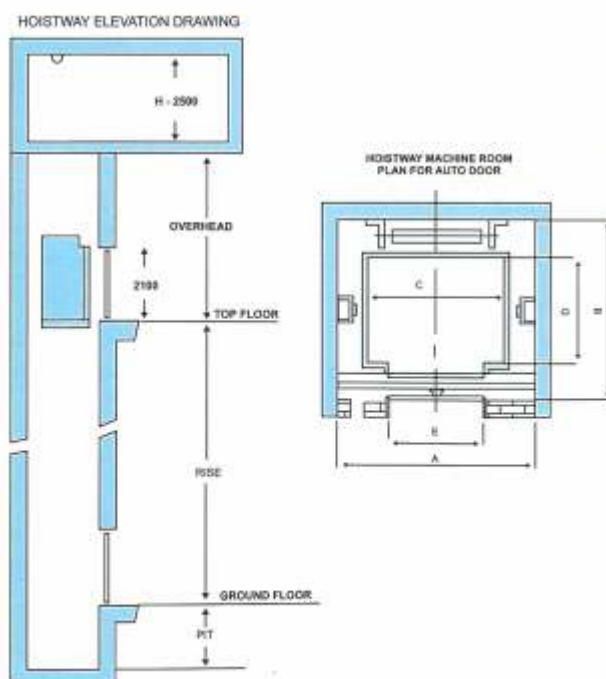

Hoist Way Machine Room Size Passenger Lift With Auto Doors

LOAD		LIFT WELL		CAR INSIDE		ENTRANCE	MACHINE ROOM			UP TO 1.5M/SEC		UP TO 2.5M/SEC	
Person	Weight	Width	Depth	Width	Depth		Width	Depth	Height	PIT	O.H.	PIT	O.H.
IN KG		A	B	C	D	E	F	G	H	K	M	K	M
6	408	1550	1650	1100	1000	800	3000	3500	2500	1600	4800	2600	6700
8	544	1900	1900	1100	1300	800	3200	3500	2500	1600	4800	2600	6700
10	680	1900	2000	1350	1300	800	3500	4000	2500	1600	4900	2600	6700
13	884	2500	1900	2000	1100	1000	4000	4200	2500	1600	4800	2600	6700
16	1088	2500	2000	2000	1300	1000	4500	4800	2500	1600	4800	2600	6700
20	1360	2500	2300	2000	1550	1000	5000	5000	2500	1600	4800	2600	6700

Goods Elevator :



Leveraging on the support of experienced professionals, we are engaged in manufacturing and supplying a wide range of **Goods Elevators**. Our offered goods elevators are able to fulfill the requirements of patrons to ensure the same, we provide these as per their given details. Moreover, we manufacture these goods elevators by using optimum quality raw material so as to ensure their compliance with the universally accepted quality standards.

HIGHLIGHTS :

Max. Speed : 1m/sec
Max. Load : Up to 5,000kg
Max. Travel : 40m
Max. Stops : 12 Stops

FALCON Goods lift is specifically designed to provide the vertical travel needs of the moving freight and heavy cargo in various industries. The Elevators in this series are built to provide robust vertical transport, energy efficiency, faster travel and higher uptime. Sturdy enough to withstand rough treatment, these Lifts may be used to carry various type of material like Raw material or finished goods in various types of environments. We can provide lifts for Hazardous areas where Flame proof elevators are required.

FALCON Goods Lifts provides a smooth ride to handle fragile loads, leveling accuracy for easy loading and unloading, and wide doors that maximize in-car space.

Efficient mobility

Sustainable technology

Features of Goods Elevators are listed below:

- Need less maintenance
- Resistance against abrasion
- Sturdy construction
- Longer service life
- Fine finish
- Durability
- Easy maintenance
- In-tandem with the industry set quality standards

Technical Specifications

HOISTWAY ELEVATION & PLANS

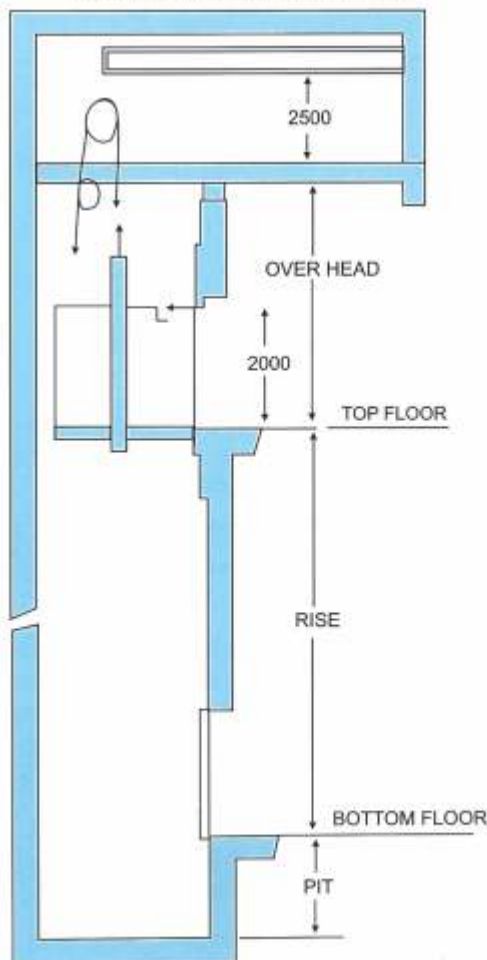

HOIST WAY MACHINE ROOM SIZES

Capa- city	Car Inside		Lift Well		Clear Opening	Wall Opening	Machine Room			Pit Depth	Over Head	Speed
Load in Kg.	A	B	C	D	E	F	G	H	Hei- ght			Mt/ Sec
500	1200	1200	1650	1650	800x2000	1150x2225	2700	2700	2500	1600	4800	0.35
1000	1700	1600	2400	1900	1200x2000	1625x2225	3500	3000	2500	1600	4800	0.35
1500	2000	2000	2700	2300	1500x2000	2000x2225	4000	4000	2500	1600	4800	0.35
2000	2200	2500	2900	2800	1500x2000	2000x2225	4000	4200	2500	1600	4800	0.35
2500	2500	2500	3200	2800	1600x2000	2100x2225	4500	4500	2500	1600	4800	0.35
3000	2500	3200	3300	3500	1600x2000	2100x2225	4500	5200	2500	1600	4800	0.35
4000	2500	4000	3400	4300	2000x2000	2600x2225	4500	6300	2500	1600	4800	0.35

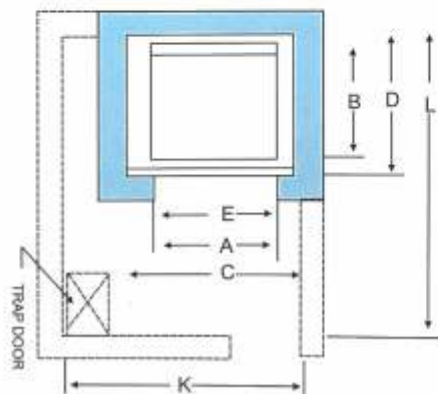

Hospital Elevator :



Our organization holds expertise in manufacturing and supplying a comprehensive range of **Hospital Lifts**. Our offered hospital elevators are able to serve patrons for long as these are manufactured by making use of the high-quality raw material, procured from the most authentic vendors of the industry. Post production, we make these hospital elevators pass a quality check so as to ensure their compliance with the defined quality standards and norms.

HIGHLIGHTS :

Max. Speed : 1.75m/sec
Max. Load : Up to 2,000kg
Max. Travel : 75m
Max. Stops : 24 Stops

Easy mobility for beds, equipment and people

With **FALCON** hospital Lift, patients and staff will be able to move smoothly and safely. FALCON Hospital Lift provides optimum performance in this highly demanding environment.

It has a large capacity and wide opening doors to accommodate stretchers, beds TOGETHER with accompanying staffs and medical equipment. **FALCON** Hospital lift is also specifically designed for high accessibility for those with special mobility requirements.

The perfect fusion of people-centered design and technology

Features of Hospital Elevators are listed below:

- Resistance against abrasion
- Easy maintenance
- Smooth finish
- Durability
- Power efficiency
- Longer service life
- Fine finish
- Sturdy construction
- Easy to install

Technical Specifications

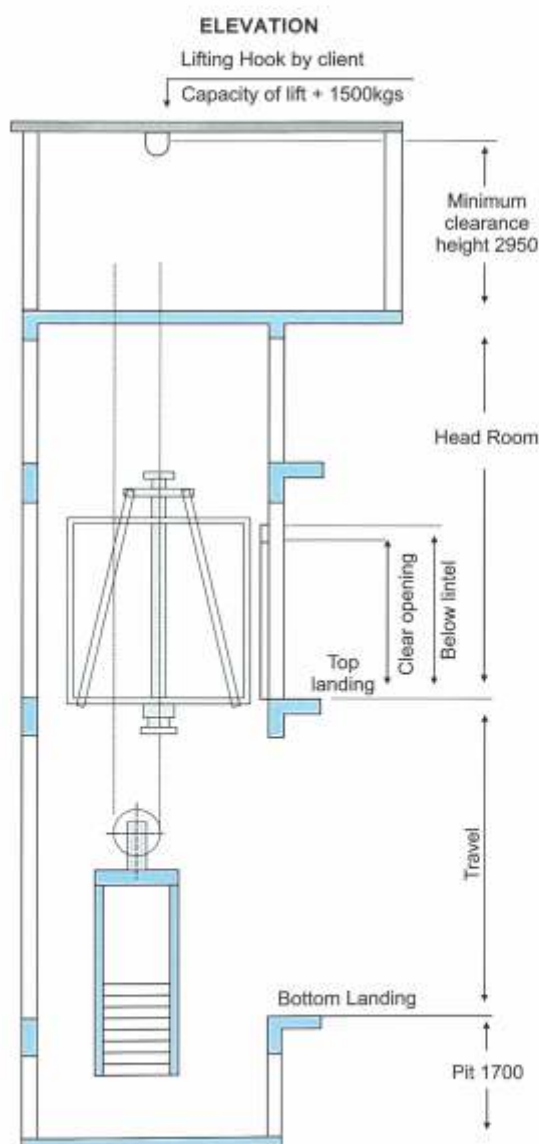

DIMENSIONAL DETAILS : HOSPITAL LIFT

Type	Capacity	Car Inside		Lift Well		Clear Entrance	Clear Opening at Landing	O.H.	Pit	Speed
		A	B	C	D					
Wheel Chair	544kg	1100	1300	1700	1850	800	920x2150	4200	1600	3mps
Stretcher	750kg	1000	2100	1700	2500	800	920x2150	4400	1600	33mps
Small Bed	1020kg	1200	2100	1900	2500	900	1120x2150	4400	1600	35mps
Standard Bed	1360kg	1600	2400	2500	2800	1200	1420x2150	4400	1600	35mps

All Dimensions are in mm size.

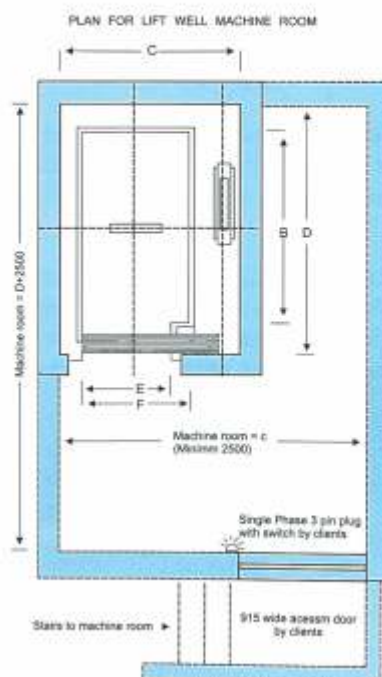

Machine Room Less (MRL) Elevator :



With a wealth of experience, we are perfectly placed to provide both commercial and residential customers with innovative **Machine Room-less Elevators** that save space and installation costs.

HIGHLIGHTS :

For low-rise buildings

Max. Speed : 1m/sec
Max. Load : Up to 680kg
Max. Travel : 24m
Max. Stops : 8 Stops

For mid & high-rise buildings

Max. Speed : 1.75m/sec
Max. Load : Up to 2,000kg
Max. Travel : 75m
Max. Stops : 24 Stops

The concept of MRL Lifts is that all equipment is located in the lift well. The lift drive systems are placed within, or adjacent to the lift shaft, therefore a separate motor room is not required. Often this will free up valuable space for an alternative use for the machine room and in case of a new building, it reduce construction costs.

Machine Room Less Lift (MRL Lifts) can be either electric traction or hydraulic, arrangements are available with the machine located in the pit or headroom and for hydraulics, we mount the machinery in a cabinet adjacent to the lift shaft.

Technical Specifications

HIOSTWAY ELEVATION DRAWING

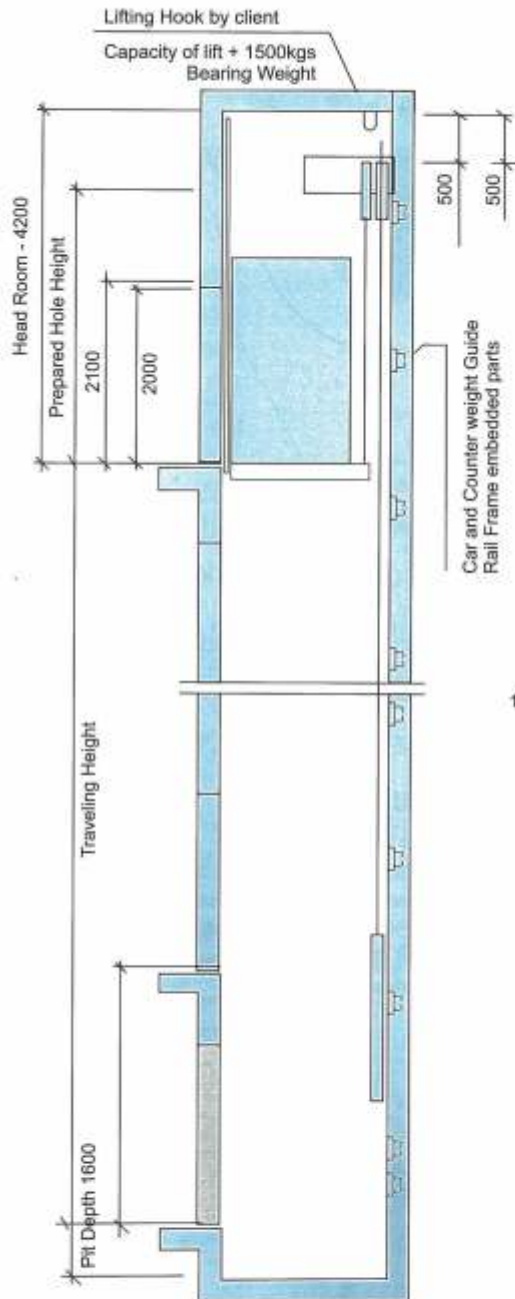

Capacity		Lift Well		Car Inside		Clear Entrance		Clear Opening at Landing	
Person	KGS	C	D	A	B	E	F	F	
6	408	1800	1400	1200	900	700	780/2100	1450/2350	
8	544	1900	1600	1300	1100	800	880/2100	1600/2350	
10	680	1900	1800	1300	1300	800	880/2100	1600/2350	
13	884	2200	1900	1600	1400	900	980/2100	1700/2350	

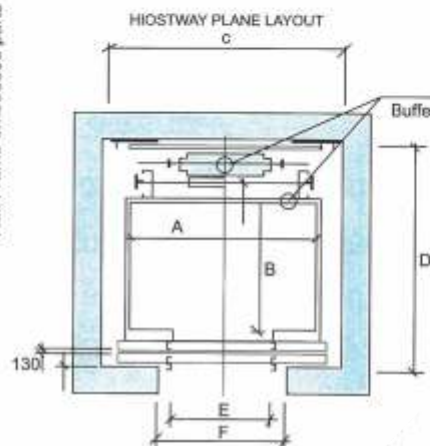

Home Elevator :



Home Elevators are outstanding, successful, customized home lifts, ideal for vertical transport requirements and for overcoming architectural barriers in both public and private buildings. It is the ideal solution for elderly persons and those with impaired mobility who gain independence and freedom from stairs. The automatic sliding doors, and swing doors are available which offer a user-friendly use like any traditional lift.

FALCON HOME ELEVATOR

Our gearless home elevators are trademark of safety and luxury. These home lifts are perfect for bungalows, Villas & private residences. These home lifts are tailor made and hence can be installed in the minimal space & inside or outside your premises. We require no pit, no headroom and our lifts operate on just single phase power supply. Apart from this our major focus has always been on safety, since we realize that our lifts will be used specially for residential purpose and we guarantee you that these lifts are 100% safe even for kids to use.

Gearless Home Elevator are based on the permanent magnet technology with high efficiency and have high torque performance, which completely eliminate the gear box.

Whether you are constructing a new home or looking forward to installing a new elevator unit in your home, **FALCON** Lifts serves to be your one-stop solution for all your unique home lifts & residential elevator requirements.

FEATURES :

Home Elevator Series can be designed to perfectly match your personal style and home decor. With two options, classic and modern, you can pick your style and then customize everything from your cabin walls to floors to lighting.

State-of-the-art planning, installation and support

Technical Specifications

Load		Lift Shaft		Car Inside		Clear opening	Pit	Overhead
Persons	kgs	width	depth	width	depth			
3	204	1400	1375	800	1000	800	550	2700
		1400	1375	800	1000	800	550	2700
4	272	1400	1575	800	1200	800	550	2700
		1400	1625	800	1250	800	550	2700
5	340	1450	1575	900	1200	800	550	2700
		1450	1625	900	1250	800	550	2700
6	408	1500	1500	1000	1100	800	550	2700
		1600	1675	1100	1200	800	550	2700

HOISTWAY ELEVATION DRAWING

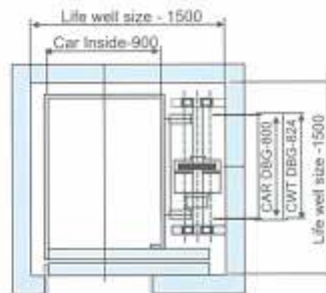
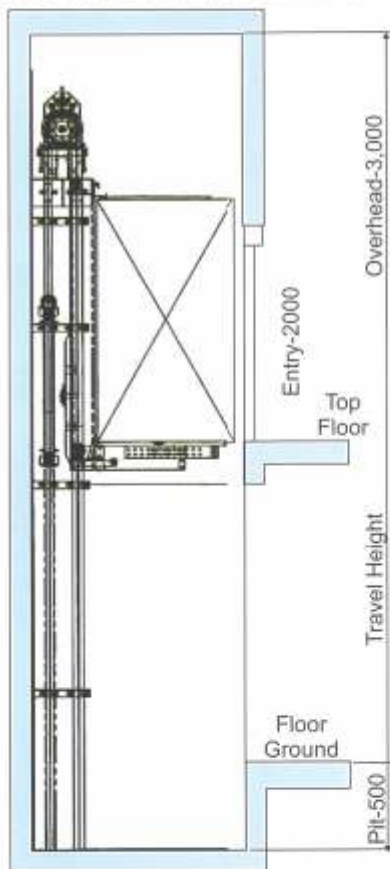

HOISTWAY PLAN LAYOUT

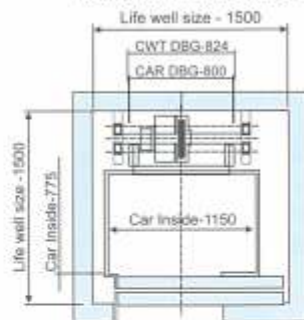

SPECIFICATION

RPM	120	Pulley Dia	100mm
Frequency	12Hz	Rope Dia	4mm
Voltage	230 VAC	No. of Ropes	4
Kw/ Hp	0.75/1	Lifting Capacity	300kg
Weight	70kg	Lift Speed	0.32 m/s
Brake	Pick-up :220 VDC	Max. Travel	15 Mts
voltage	Holding : 110VDC	Starts/Day	100



Home Lift Iron Structure with side Glass Cladding

Dumb Waiters Lift : //



Dumbwaiters Carry food and plates from Kitchen to Room, Kitchen to kitchen or from kitchen to the place of serving. the cabin and the doors of all the dumbwaiters are manufactured using stainless steel. The vertical bi-parting doors are well suited to optimize the space utilization. The Dumbwaiter travel so smoothly that each time it travels you can ensure no damage to your valuable crockery

To compete with current standards of the international industry we are committed in supplying a high performing range of dumb waiters. under the supervision of adroit professionals, the provided waiters are manufactured with the aid of pioneering technology in tune with the international quality standards. used in heavy duty industries these waiters are available in different technical specifications in addition these dumb waiters are taken on defined parameters in order to ensure their longer working life and performance

Features of **Dumb Waiter Lifts** are listed below :

- Noise less operation
- Power efficient
- Rugged construction
- Excellent performance
- Compact
- Highly usable
- Minimum down time
- Economical

State-of-the-art planning, installation and support

Technical Specifications

Load	Lift Shaft		Car Inside			Clear opening	Speed (M.P.S)
	width	depth	width	depth	Height		
100	1200	900	700	700	800	700	0.3
150	1300	1000	800	800	900	800	0.3
200	1400	1100	900	900	1000	900	0.3
250	1500	1200	1000	1000	1200	1000	0.3

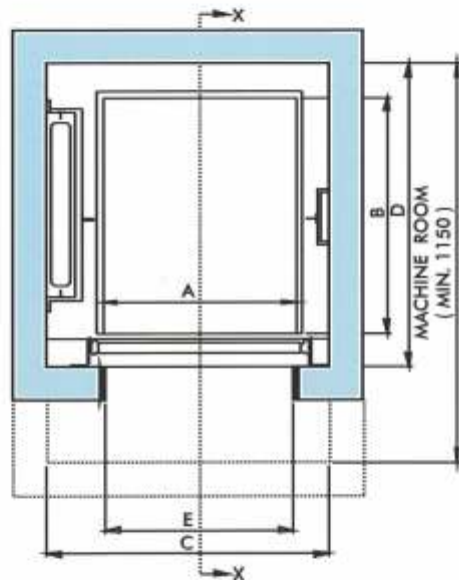

LIFT SHAFT, CAR, C.W. & MACHINE ROOM PLAN

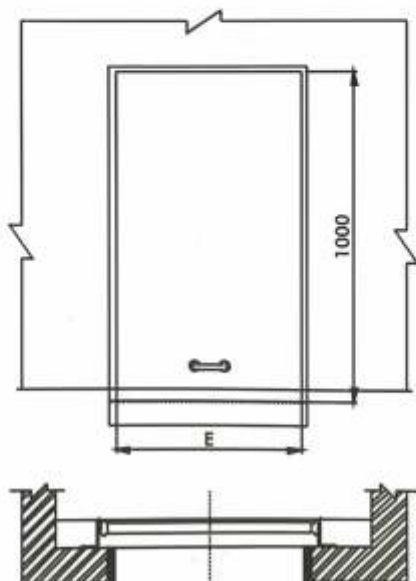

VERTICAL SLIDING DOOR LANDING

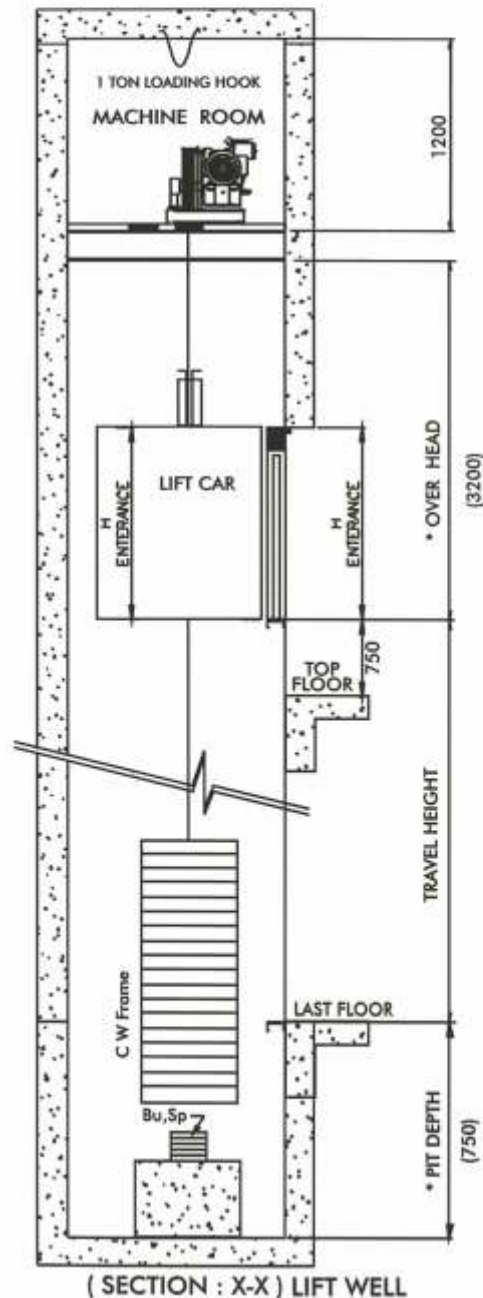

(SECTION : X-X) LIFT WELL

Hydraulic Elevator :



To stand tall on the expectations of patrons, we are engaged in supplying **Hydraulic Lifts**.

These hydraulic elevators are manufactured by making use of the quality assured raw material and other components. In addition to this, our professionals keep in mind the established quality standards of the industry while manufacturing these hydraulic elevators so as to ensure their peerless standards.

Hydraulic elevators are elevators which are powered by a piston that travels inside a cylinder. An electric motor pumps hydraulic oil into the cylinder to move the piston. The piston smoothly lifts the elevator cabin. Hydraulic elevators are used extensively in buildings up to five or six stories high.

Features of **Hydraulic Elevators** are Listed Below:

- Robust construction
- Easy maintenance
- Easy to install
- Durability
- Easy operations

Car frame T509

Traction 2:1. Designed for any kind of building thanks to the reduced pit (150 mm). Ideal to transport passengers in single family installations. It is supplied with a low pit safety device according to EN 81.41.

Car doors

Available door types: Power operated (2AT- 2AO - 3AT). Semiautomatic (bus door in car and manual landing door). Without car door (with light curtain technology)

Control panel

Easy to install, setting at work and maintenance with LED signal inputs and output indicators-LCD display. Robust push-buttons. Diagnostic tool provided for installation, parameter settings, repair and, maintenance, allowing to find code errors.

Furthermore it supplies:

- Automatic re-leveling
- Emergency lowering device to main floor in case of black-out
- Automatic push-button or constant pressure controller
- Car light timer

Cabinet

Cabinet of reduced dimensions that can be located anywhere at home within a radius of approximately 15 m.

Power unit

Power unit located in a machine room or, thanks to its reduced size, anywhere to optimize the housing space. The power unit can be equipped with NGV electronic valve.

Very high comfort and very low consumption thanks to its outer motor (DRY).It complies with the Machine Directive 2006/42/EC.

Structure

We can provide steel structures for indoor or outdoor use, with any possible finish (steel or glass), perfectly matching any new or existing building type. The technical structure specifications are calculated depending on each installation, in compliance with any national standard or regulation.

Landing doors

Door models available: power operated doors 2AT-2AO-3AT, hinged doors (Car bus door and manual at landings), Manual doors (without car door). Available finishes: Polimod, Plastic laminate, Plastic coated sheet steel (Skinplate), Stainless Steel, Panoramic glass or RAL painted. Quick and easy to assemble and adjust.

1008 SL piston

Maximum shaft optimization. Less fluid quantity used. Quick and easy to install thanks to its design.

Car

Designed to fit into any furnishing type. Car wall panels available in Skinplate, Plastic Laminate or Stainless Steel. Several ornamental solutions are possible. Very robust floor and roof. Car lighting available with led or fluorescent neon tubes. Easy access to the shaft through a hatch in the car roof.

Flexible hose

Designed with inner synthetic rubber coat, with one or two high resistance spirals. The outer layer of synthetic rubber provides excellent resistance.

Eco-fluid

It guarantees the best results and very high performance over the years. It betters the performance of the NGV valve. Best filtration with or without water. Excellent anti-corrosion, anti-oxidant and anti-foam results. Very low freezing point.

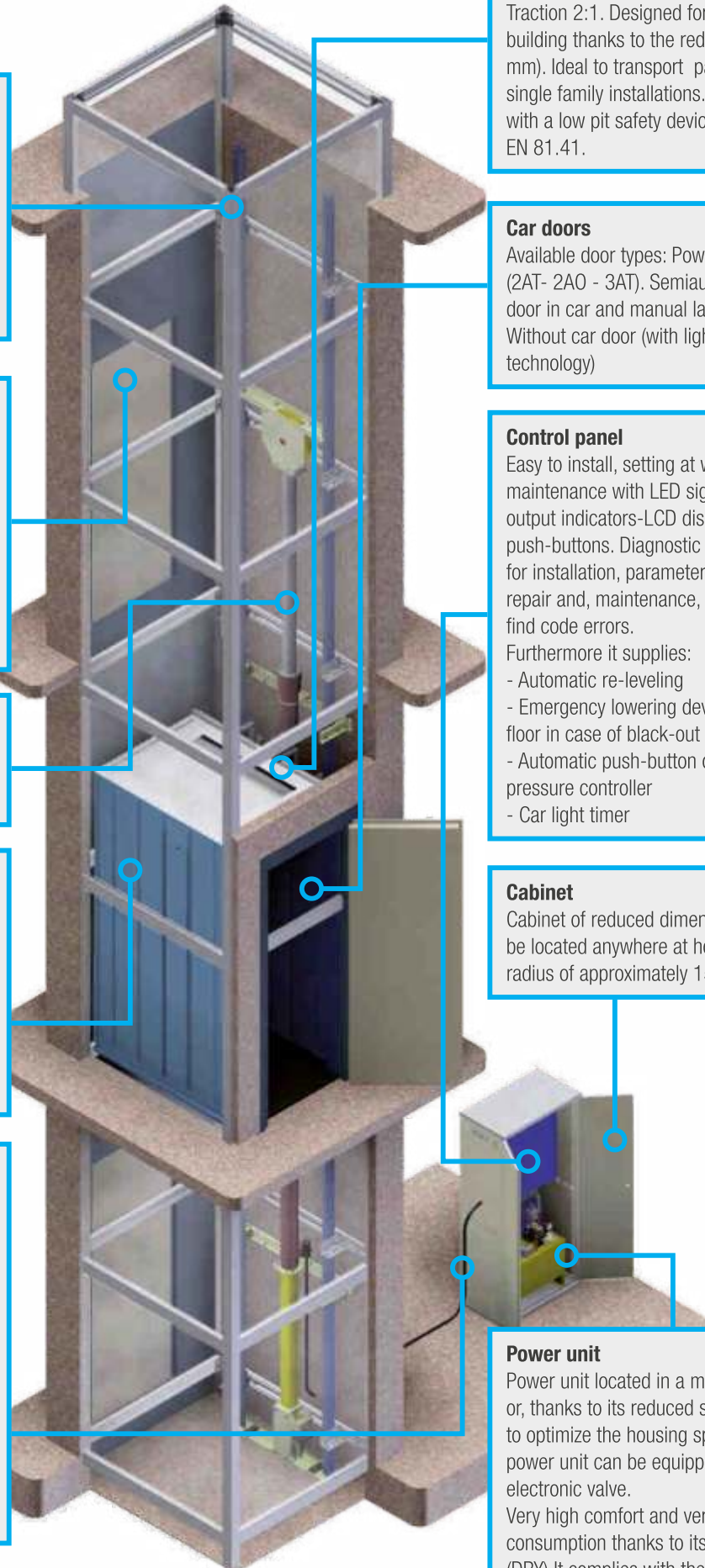

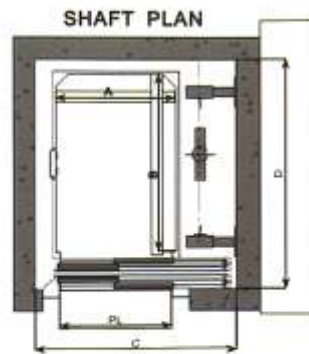

MACHINERY CABINET

Cabinet	Dimension [mm]			Payload
type	Width	Depth	Height	[kg]
B	950	570	2100	900-1025
C	870	400	2100	320-630
D	780	350	2060	320-630
F	1000	650	2100	900-1025

The diagram illustrates the experimental setup for the water column experiment. It shows a vertical column with a controller at the top, a power unit in the middle, and a water column at the bottom. The column is labeled with 'Height' and 'Depth'. The water column is labeled with 'Width'.

Available with reduced pit and/or head room	Payload [kg]	No. of Passen- gers	Entrances [No]	Car dimensions [mm]	Clear door opening [mm]	Min. shaft dimensions with doors opening at side [mm]	Min. shaft dimensions with central doors opening [mm]			
				A	B	PL	C	D	C	D
	320	4	1	900	1000	700/800	1330/1400	1350	1550/1750	1300
	350	4	1	800	1200	750	1350	1350	1600	1500
	375	5	2 adjacent	800	1200	750	1500	1550	-	-
	450	6	1	950	1300	800/850/900	1400/1500/1550	1650	1750/1800/1900	1600
	450	6	1	1000(*)	1250(*)	800/850/900	1450/1500/1550	1600	1720/1800/1900	1550
	450	6	1	1100	1100	800/850/900	1530/1550/1550	1450	1750/1850/1900	1400
	480	6	2 adjacent	950	1300	800/850/900	1650/1650/1720	1650/1670/1750	-	-
	480	6	2 adjacent	1000(*)	1250(*)	800/850/900	1700/1700/1720	1600/1670/1750	-	-
	480	6	1	100	1300	800/850/900	1450/1550/1600	1650	1750/1800/1900	1600
	480	6	2 opposite	950	1300	800/850/900	1400/1500/1550	1800	1700/1800/1900	1740
	480	6	2 opposite	1000(*)	1250(*)	800/850/900	1450/1500/1550	1750	1700/1800/1900	1730
	480	6	2 opposite	1100	1100	800/850/900	1530/1550/1550	1600	-	-
	480	6	2 adjacent	1100	1100	800/850/900	1800	1600/1670/1750	-	-
	500	6	2 opposite	1000	1300	800/850/900	1450/1550/1600	1800	-	-
	525	7	2 opposite	1000	1300	800/850/900	-	-	1700/1800/1900	1740
	525	7	2 adjacent	1000	1300	800/850/900	1700/1700/1720	1650/1670/1750	-	-
	600	8	2 adjacent	1200	1200	800/900	1900	1600/1750	-	-
	630	8	1	1100(*)	1400(*)	800/900	1550	1750	1750/1900	1700
	630	8	2 opposite	1100(*)	1400(*)	800/900	1550	1900	1700/1900	1840
	630	8	2 adjacent	1100(*)	1400(*)	800/900	1800	1750	-	-
	800	10	2 adjacent	1300	1400	900/1000	2000	1850/1900	-	-
	900	12	1	1400	1500	900/1000	1850	1850	2000/2150	1850
	920	12	2 opposite	1400	1500	900/1000	1850	2000	2000/2150	1940
	920	12	2 adjacent	1400	1500	900/1000	2100	1850/1900	-	-
	1000	13	1	1100	2110	900/1000	1680/1700	2450	1950/2150	2420
	1025	13	2 opposite	1100	2110	900/1000	1600/1650	2600	1950/2150	2550

Attention the measurements given in the table are indicative. For any feasibility contact our technical department Max car travel: 19 m up to 630 kg - 16 m for higher payloads

Standard		Standard Speed for each payload							
Speed	Upward	0.40		0.52		0.62		0.86	
[m/s]	Downward	0.40	0.48(**)	0.52	0.62(**)	0.62	0.74(**)	0.86	1.00(**)

CEILING & LIGHTING



False Ceiling

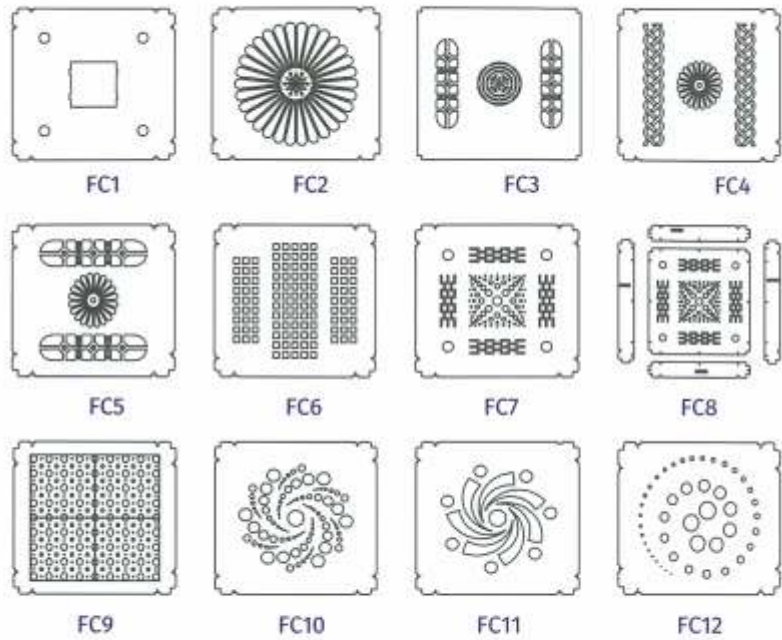

FLOORING



DECORATIVE PATTERNS

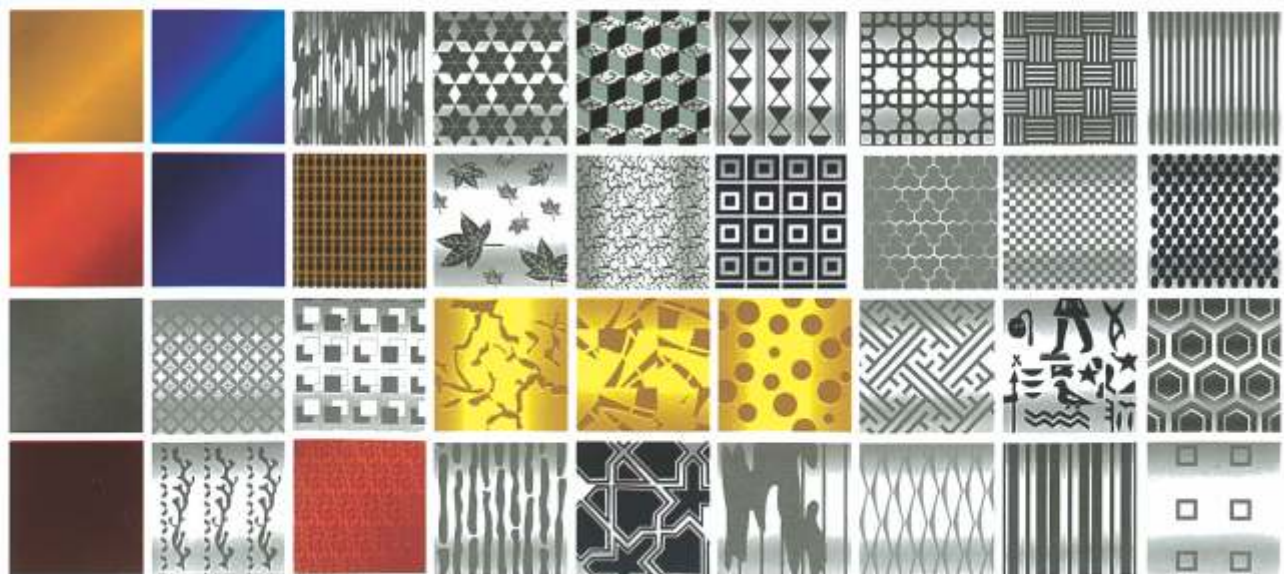



Premium Cabin Designs



CONTROL PANEL BOARDS

The controller is integrated with intellectual 16 bit / 32 bit micro processor control which can also be used for a group of elevators. VVVF drive is an integral part of all our controllers facilitating the optimum speed control system and achieving the best curves there by accurately adjusting the motor speed to accomplish the perfect soft feel when the elevator starts, stops or accelerates. This system also guarantees leveling accuracy, high efficiency and enormous energy saving.



Micro Processor Control Panel



Automatic Rescue Device (ARD)

TYPES OF HANDLES



SWITCHES & DISPLAYS COP'S & LOP'S

Scrolling Dot matrix display & LCD Display

The Scrolling display touch of class

1. Scrolling standard elevator new age
2. Floor indication - Alpha numeric

The monochrome LCD Display option comes with a host of friendly features

1. Scrolling Arrow
2. Floor Indication
3. Real time Clock date
4. Standard elevator messages



Falcon Manual Door Design's



HOME LIFT



HOME LIFT GLASS DOOR



MS SWING DOOR



WOODEN SWING DOOR



COLLAPSIBLE GATE



MS SWING DOOR



IFG DOOR



TELESCOPIC MANUAL DOOR



TELESCOPIC BIG VISION MANUAL DOOR



SS CENTER OPENING AUTO DOOR



SS CENTER OPENING GLASS DOOR



SS CENTER OPENING VISION PANEL DOOR



SS TELESCOPIC AUTO DOOR



SS 3 PANEL TELESCOPIC AUTO DOOR



SS SIDE OPENING HALF VISION PANEL DOOR



MS CENTER OPENING AUTO DOOR



SS CENTER OPENING AUTO DOOR



SS CENTER OPENING SMALL VISION PANEL DOOR

Single Phase 230Volts Power Supply No Need of 3 phase current [Power]

GREENSTAR MINI

Over 70 years of enterprise in putting technology to work, bear testimony to GreenStar Mini evolution from a pioneer of electrical engineering in India to one of the biggest and most trusted names in the industry today.

Our product portfolio includes power transformers, induction motors, electrical projects, pumps, special maintenance products, AC and DC drive systems and gearless machines for elevators. The common thread is our abiding concern for quality.

PMSM Gearless Machine for Home Elevators

- The new GreenStar Mini simplifies vertical mobility inside your home.
- Travel comfortably to every floor.
- Give elderly and dependent people the freedom to move from floor to floor without using the stairs.
- GreenStar Mini is a Gearless PMSM machine , ideal for loads up to 300kg and travel up to 15 meters.
- GreenStar Mini is compact and facilitates elevators with a minimum of space and civil work.
- GreenStar Mini operates on single-phase 230V domestic supply .
- GreenStar Mini is silent, It uses no oil, reduces power consumption and is also eco-friendly.



Model No.	Duty Load (KG)	Equivalent Pairs Capacity (Nos.) Up To	Speed (m/s)	Roping	No. of Ropes	Rope Dia (mm)	Pulley Dia (mm)	Rated Current (A)	Rated Output Power		Voltage (V)	RPM	Rated Torque (Nm)	No. of Poles	Rated Frequency (Hz)	Machine weight (kg) Approx.
									(Kw)	(HP)						
Gh04 200 032	300	4	0.32	2:1	4	6	200	4.0	0.62	0.84	230	60	100	12	6	90



NO MACHINE ROOM



GEARLESS



LOW NOISE



**ENERGY SAVING
UPTO 30%**



COMPACT DESIGN

State-of-the-art checks trained and competent persons...

GC 06

Technical Specifications

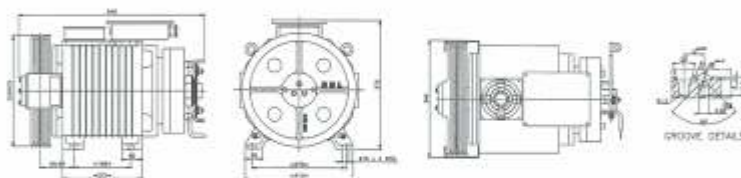

Model	GC06-320-100	GC06-320-125	GC06-320-150
Duty Load (KG)		408	
Passenger Capacity		6	
Speed upto (m/s)	1.0	1.25	1.5
Sheave Dia. (mm)		320	
Rope Dia. (mm)		8	
No. of Ropes		4	
Roping Ratio		2:1	
RPM	120	150	180
Rated frequency (Hz)	12	15	18
Rated Torque (Nm)		215	
Rated Output Power			
(kW)	2.7	3.4	4.0
(HP)	3.6	4.5	5.4
Rated Current (Amp)	8.0	10.0	10.0
Starts / Hour		120	180
Static Load Kg		1300	
Machine Weight (Kg)		120	

GC 08

Technical Specifications

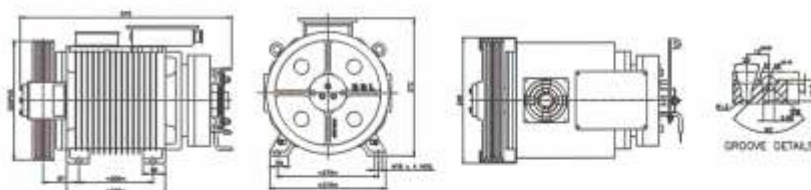

Model	GC06-320-100	GC06-320-125	GC06-320-150
Duty Load (KG)		544	
Passenger Capacity		8	
Speed upto (m/s)	1.0	1.25	1.5
Sheave Dia. (mm)		320	
Rope Dia. (mm)		8	
No. of Ropes		4	
Roping Ratio		2:1	
RPM	120	150	180
Rated frequency (Hz)	12	15	18
Rated Torque (Nm)		270	
Rated Output Power			
(kW)	3.4	4.2	5.0
(HP)	4.5	5.6	6.7
Rated Current (Amp)	9.4	11.0	13.0
Starts / Hour		120	180
Static Load Kg		1300	
Machine Weight (Kg)		150	

World-Class Italian Manufacturing Technology

MGI27S

MGI27S gearless machines is available for loads up to 480 kg, 2:1 with sheave diameter up to 320 mm. The protruding sheave (cantilever) allows an easy insertion of the ropes and facilitates any possible maintenance. The range of MGI27 machines grants both a smoothness of operation and the max. facility in regulating the main Inverter. Levers for manual Brake release are supplied as standard. All brakes have passed 3 million cycles durability test.

Features

• Static Load	1,600kg
• Normal Torque	250Nm
• Motor Weight	120kg
• Working Duty	S5-40% ED 180s/h
• Encode Type	ENDAT, SIN COS, SSI
• Brake Type	DSZ-400MTX(2x400Nm)
• Brake Power	207V 200W

Technical Specification

	Traction Sheave (MM)		Dimensions (MM)			
Gearless Type	OD	F	A	B	C	E
MGI27S	240	80	486	300	344	52.5
MGI27S	320	75	486	344	357	49.5

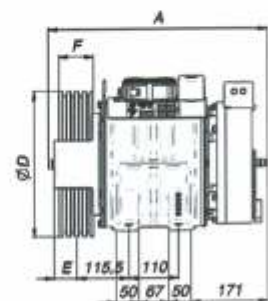
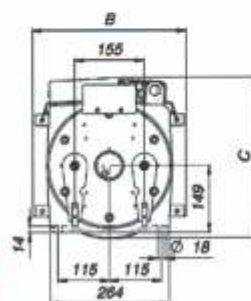
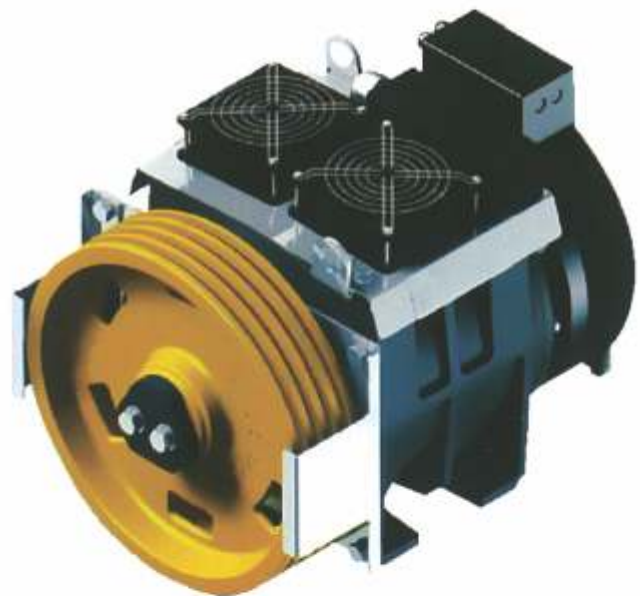

GEARS



M67

- Compact gear with load up to 408kg in roping 1:1
- Static Load 2,200kg



M98

- Gear with load up to 2,000kg in roping 1:1
- Static Load 7,000kg



M77

- Gear with load up to 680kg in roping 1:1
- Static Load 2,300kg



M109

- Gear at the top of the range for high load and speed. Load up to 5,500kg in roping 1:1
- Static Load 15,000kg



M87

- Gear with load up to 816kg in roping 1:1
- Static Load 3,200kg



M93

- Gear with load up to 1500kg in roping 1:1
- Static Load 5,000kg

All brakes have been tested and certified for 3,000,000 cycles

Safety Devices

OVERSPEED GOVERNORS

- From 0.15 to 44m/sec
- Suitable for mono or bidirectional safety gears



TENSION DEVICES

- Available for standard or MRL application



SAFETY GEARS

Instantaneous & Progressive

- Instantaneous up to 4,000 kg (P+Q)
- Progressive up to 6,400kg (P+Q)
- Bidirectional up to 4,100 (P+Q)



TRACTION MACHINES



GEARLESS TRACTION MACHINE



SEG - 5

Duty Load (Kg)	270 to 408
Speed (m/sec)	0.32 to 0.50
Static Load (Kg)	1000
Sheave Diameter (mm)	160, 200
Power (Kw)	0.6 to 1.3
Roping	2:1
Weight of Machine (Kg)	113



SEG - 10

Duty Load (Kg)	340 to 544
Speed (m/sec)	0.65 to 1.50
Static Load (Kg)	1700
Sheave Diameter (mm)	240, 320
Power (Kw)	1.4 to 5.3
Roping	2:1
Weight of Machine (Kg)	143



SEG - β1

Voltage (V)	400 V
Suspension	2:1
Brake	110V DC
Static Load (Kg)	2000
Encoder	ERN 1387
Pole	12
Ins. Class	IP 42
Rating	S5[40%]

ELEVATOR ROPES

Elevator Ropes, unlike wire ropes for other application, demand much closer dimensional tolerance and stringent material quality levels to meet its tough safety requirements.

Our product mix includes the HOIST Ropes, Compensating Ropes, Governor Ropes and control Ropes used in Traction Drive Elevators and Roped Hydraulic Lifts.

Pre-Stretching

It is a specialized process opted for removing the constructional stretch (a permanent stretch which occurs shortly after the elevator rope is installed) from the wire rope. Our pre-stretched ropes are processed off-line, on a specially designed P/S bed, utilizing a longer length of rope and subjecting it to suitable load for sufficient number of cycles until it stabilizes. This process has been found to be the most effective in reducing the constructional stretch of a wire rope and is much superior to on-line pre-stretching

Optimum Performance and Consistency

A simple way to ensure performance and consistency is to make sure that you are using Specific Designed Rope



Unique identification tag

Manufacturing Process

Manufacturing Machines

Some of these manufacturing machines are:

- State-of-the-art **Pickling** (cleaning and coating) Plant
- **Patenting Furnaces** employing latest technology
- Sophisticated **Die Shop**
- A number of Wire drawing machines fitted with customized control mechanism
- **Standing and closing** machines of varying type & size, each having latest technology and excellent systems

					
PSPO BROWN GLOSS	USHA BROWN GLOSS	CHOCOLATE BROWN GLOSS -2	HARDWARE BROWN GLOSS	PINK GLOSS	TELE MAGENTA GLOSS
					
ORANGE GLOSS -1	RED ORANGE GLOSS	SAFEX RED GLOSS	P O RED GLOSS	SIGNAL RED GLOSS	WINE RED GLOSS
					
MAROON GLOSS-2	RAL 7035 GLOSS	PEBBLE GREY GLOSS	MUNSHILL GREY GLOSS -2	LIGHT GREY GLOSS	SMOKE GREY GLOSS
					
D A GREY GLOSS	PURPLE GLOSS	BLACK GLOSS	SUPER JET BLACK GLOSS	SIGNAL WHITE GLOSS PP	TRAFFIC WHITE GLOSS PP
					
PURE WHITE GLOSS PP	OFF WHITE GLOSS PP	DEEP BLUE GLOSS PP	PEPSI BLUE GLOSS PP	ONAN GREEN GLOSS PP	IVORY GLOSS PP
					
MID BUFF GLOSS PP	GOLDEN YELLOW GLOSS PP	TAKE WOOD BROWN GL PP	NUT BROWN GLOSS PP	TELE MAGENTA GLOSS PP	SIGNAL ORANGE GLOSS PP
					
SAFEX RED GLOSS - PP	P O RED GLOSS PP	SIGNAL RED GLOSS PP	WINE RED GLOSS PP		
					
SATIN FINISH	MRP BROKEN WHITE SATIN	WHITE SATIN	SIGNAL WHITE SATIN-2	PURE WHITE SATIN-2	SKY BLUE SATIN -2
					
KANGAROO BLUE SATIN	LISTA BLUE SATIN	PARROT GREEN SATIN	RELIANCE GREEN SATIN	WATER GREEN SATIN	CREAM SATIN
					
LIGHT BEIGE SATIN	IVORY SATIN	SAND BEIGE SATIN- 2	WOOD YELLOW SATIN	YELLOW ORANGE SATIN	BEIGE BROWN SATIN
					
LIGHT ORANGE SATIN	RAL 7035 SATIN	PEBBLE GREY SATIN	SIGNAL GREY SATIN	STEEL GREY SATIN	LIGHT ADMIRALTY GREY SATIN
					
LIGHT GREY SATIN-3	BLACK SATIN - 806	PARA BLACK SATIN	BLACK SATIN - 803	PURE WHITE SATIN PP	CREAM SATIN PP
					
GREY WHITE SATIN PP	IVORY CLASSIC SATIN PP	INDIA BROWN SATIN PP	BCB SATIN PP	NUT BROWN SATIN PP	TRAFFIC RED SATIN PP
					
RAL 7035 SATIN PP	PURPLE RED SATIN PP	BLACK SATIN - 805 PP	BLACK SATIN 1805 PP		



SAFETY | QUALITY | 100% CUSTOMIZATION

Office Address : 1st Floor, Plot 142, SN Colony, Kurnool - 518003
Email : bfgserviceglobal@gmail.com | Ph : +91 98666 93615